



Disborooof 412 Dachschicht

Elastic, acrylic dispersion-based roof coating. Suitable for pitched roofing made of fibre cement boards, bituminous waterproof sheeting and welded asphalt sheeting, and for fibre cement shingles on vertical surfaces.

Product Description

Field of Application	Surface protection for pitched roofing made of fibre cement boards/panels, bituminous waterproof sheeting (bitumen roof sheeting) and welded bituminous sheeting. Suitable for fibre cement shingles on vertical surfaces, e.g. barge boards, fascia boards, chimney and gable surfaces; not suitable for roofing made of fibre cement shingles.	
Material Properties	<ul style="list-style-type: none"> ■ Highly resistant to weathering and environmental influences ■ High elasticity, even at low temperatures ■ Water vapour permeable and waterproof ■ Due to the thixotropic consistency, a high layer thickness per coat is achieved 	
Material Base / Vehicle	Acrylic dispersion	
Packaging/Package Size	15 litres plastic bucket	
Colours	Dark Brown, Slate, Concrete Grey and Brick-Red. Special tints are available on request.	
Gloss Level	Matt (flat)	
Storage	Keep in a cool, dry, and frost-free place. Shelf life of the original, tightly closed packaging: min. 1 year.	
Technical Data	<ul style="list-style-type: none"> ■ Density: ■ Solids content: ■ Dry film thickness: ■ Resistance-count for diffusion μ (H₂O): ■ Ultimate elongation to DIN 53504: 	<p>approx. 1.5 g/cm³</p> <p>approx. 73 % by weight</p> <p>approx. 60 μm/100 ml/m²</p> <p>approx. 560</p> <p>approx. 250 %</p>

Application

Suitable Substrates	Fibre cement boards as well as bituminous waterproof sheeting and welded bituminous sheeting after open weather exposure for at least one year. Fibre cement shingles only on vertical surfaces.
---------------------	--



Substrate Preparation

Replace or repair defective roofing and sealing materials as well as joints and connections by an appropriate roofing specialist. Provide for sufficient air space.

1. Fibre cement boards and shingles:

Remove soiling and moss or algae attack by hydraulic blasting in down-direction of the running water. Treat with Capatop and allow surfaces to dry well.

2. Bituminous waterproof sheeting / welded asphalt sheeting:

Remove soiling and moss or algae attack by hydraulic blasting. Cut open bubbles in the substrate cross-wise, allow to dry, then bond fully surfaced with Disborooof 412 Roof Coating. Ensure that no moisture is present between roofing and subconstruction.

3. Expansion joints on buildings and construction parts:

Lay the joint fabric on the prepared substrate and center above the joint. Treat with Disborooof 412 Roof Coating or Disbothan 449 PU-Deckschicht (PU Finishing Coat), depending on the application. Expansion joints, flush with the surface, must be lifted from the water level using a (non-water absorbing) hollow plastic-foam profile (see illustration).

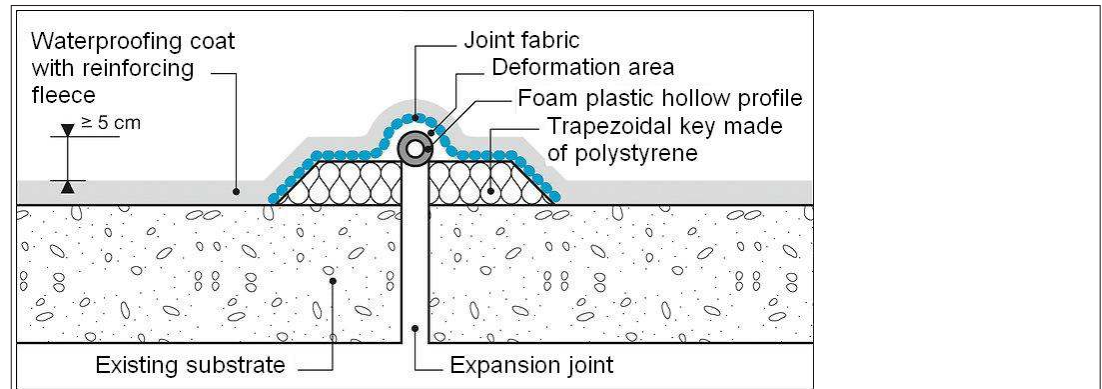

4. Bridging cracks and joints in the area of headers, roof borders, rising parts, light domes, etc.:

Lay the joint fabric on the prepared substrate and center above the joint or crack. Provide for a slight moving loop by pushing it sideways together. Then treat as described under point 3.

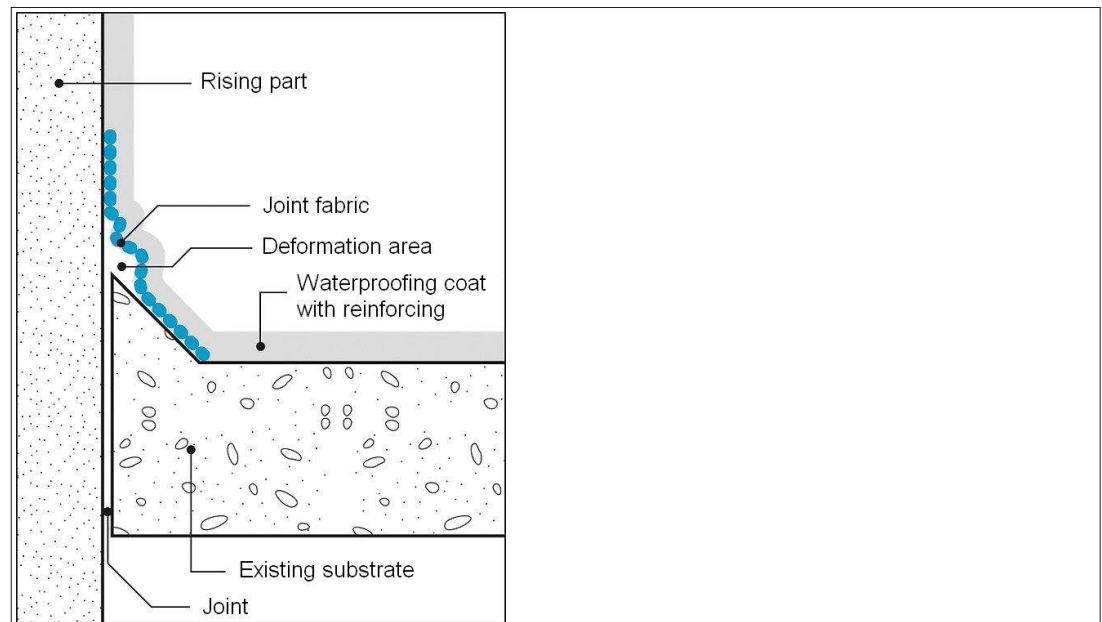

Preparation of Material

Stir the material thoroughly before use.

For priming uncoated corrugated fibre cement boards, the material should be diluted up to max. 15 % with tap (potable) water, depending on the substrate absorbency. For spray application the material is diluted up to max. 2 %.

Method of Application

Disborooof 412 Roof Coating is applied by spraying equipment (Airless, approx. 160 bar, nozzle size: 0.015 to 0.021 for fibre-cement, 0.025 to 0.027 inches for bitumen) using a suitable lengthening piece.

Surface Coating System

Fibre cement boards and shingles:

Pre-wet the substrate, then prime the matt moist surface with Disborooof 412 Roof Coating, diluted up to max. 15% with tap (potable) water, depending on the substrate absorbency. Wait approx. 24 hours, then apply the undiluted finishing coat.

Bituminous waterproof sheeting and welded asphalt sheeting:

Apply Disborooof 412 Roof Coating generously on the complete surface and embed the reinforcing fleece* crease-free, with an overlap of 10 cm. Allow the material to dry for a sufficiently long period, then apply one intermediate and one finishing coat. Apply a top sealing coat of Disboxid 449 PU-Deckschicht (polyurethane-based finishing coat) when stagnant or running water may occur temporarily.

* e.g. Paramoll N 260/150 ,TWE Dierdorf GmbH & CoKG, Poststraße 29, 56269 Dierdorf, Tel.: 02689 - 920, Fax: 02689 - 926663

Consumption

Fibre cement boards and shingles	
Priming coat	1 x 200–300 ml/m ² Disborooof 412 Dachschticht, max. 15 % waterdiluted
Finishing coat	1 x 200–300 ml/m ² Disborooof 412 Dachschticht
Bituminous waterproof sealing and welded bituminous sheeting	
Priming coat	approx. 600 ml/m ² Disborooof 412 Dachschticht
Intermediate coat	approx. 900 ml/m ² Disborooof 412 Dachschticht
Finishing coat	approx. 600 ml/m ² Disborooof 412 Dachschticht

The exact rate of consumption is best established by a trial application on site.

Application Conditions

Material, atmospheric and substrate temperature:

Min. 8 °C, max. 35 °C during application and drying.
Relative humidity must not exceed 80 %. Do not apply when rain or frost are expected or on sun heated surfaces.

Drying/Drying Time

At 20 °C and 60 % relative humidity, rainproof after approx. 2 hours, and recoatable after 24 hours. For fleece embedding, recoatable at the earliest after 36 hours, due to the thick-layered material application.

Tool Cleaning

Immediately after use with water.

Advice

German Certificates

■ 5-1022, Coating of lightning protective systems. Testing centre for lightning protection system, Oberursel

Special Risks (Hazard Note) / Safety Advice (Status as at Date of Publication)

Harmful to aquatic organisms, may cause long-term adverse effects in the aquatic environment. Keep out of reach of children. If swallowed, seek medical advice immediately and show the container or label (intestinal bacteria can be affected). Do not empty into drains, water courses or into the ground.
Apply by brush or paint roller only. Use P2 dust filter for grinding. Ensure good ventilation during use and drying. Do not eat, drink or smoke while using the paint. In case of contact with eyes or skin, immediately and thoroughly rinse with water. Clean utensils immediately after use with soap and water.

Disposal

Materials and all related packaging must be disposed of in a safe way in accordance with the full requirements of the local authorities. Particular attention should be made to removing wastage from site in compliance with standard construction site procedures.
In Germany: Only completely emptied containers should be given for recycling. Dispose containers with residues of liquid material as remnants of water-based paints and dried material as hardened paints waste or via domestic waste.

EU limit value for the VOC content

of this product (category A/c): max. 40 g/l (2010). This product contains max. 15 g/l VOC.

Product Code Paints and Enamels

M-DF 01 F

Further Details

See Safety Data Sheet (MSDS).
Follow the application recommendation while applying our products.

Other Notes

Note: Disborooof 412 Dachschticht ist provided with a preservative against deteriorations in the coating due to algal and fungal attack. By roof surfaces caught rain water should be used only after a waiting time of 12 months as a pouring water.

Customer Service Centre

Tel.: +49 6154 71-71710

Fax: +49 6154 71-71711

e-mail: kundenservicecenter@caparol.de

International Distribution: Please see www.caparol.com

Technical Information No.412 · Issue: July 2017

All suggestions and application instructions herein are based on our latest technical experience. Due to the wide variety of individual project conditions, we cannot be held responsible for their content. These instructions do not release the purchaser/ applicator from his responsibility to determine the suitability of the product in consideration of the project characteristics. These instructions are to be considered void when a new edition is released. Our general conditions of sale and delivery in their latest edition apply. This document is a translation of our German Technical Information No.412 · Disborooof 412 Dachschicht · Issued: April 2017

DISBON GmbH · Roszdoerfer Strasse 50 · D-64372 Ober-Ramstadt · Phone +49 6154 71-71719 · Fax +49 6154 71-71008 · Internet www.disbon.com